



BELMOND  
**ROAD TO MANDALAY**  
MYANMAR

DISCOVER OUR RIVER CRUISER

## BELMOND ROAD TO MANDALAY



BELMOND ROAD TO MANDALAY IS A LUXURIOUS RIVER CRUISER, WHICH GLIDES ALONG THE AYEYARWADY RIVER BETWEEN BAGAN AND MANDALAY THROUGH SCENERY THAT SEEMS UNTOUCHED BY TIME. DURING THE RELAXING JOURNEY, TAKE IN THE COUNTRY'S AWE-INSPIRING WONDERS, INCLUDING MAJESTIC TEMPLES AND MESMERISING LANDSCAPES.

### LIFE ON BOARD

#### CABINS

There are five types of cabin: Single, Superior, Deluxe and State, plus the exclusive Governor's Suite. All cabins have outward-facing windows, air-conditioning and en-suite showers and toilets. Each cabin has a personal safe, telephone, satellite TV and sockets suitable for 2-pin round plugs.

#### DINING

Our acclaimed onboard menu showcases the finest gourmet Eastern and Western delicacies, all served with Burmese courtesy and charm. Situated on the Observation Deck, the alfresco Bar & Grill Restaurant offers refined local cuisine in a truly inspiring setting. Watch the experts in action at the gourmet grill station, and savour fine wines from our vintage selection.

## BELMOND ROAD TO MANDALAY



### OBSERVATION DECK

With its plush wooden loungers and inviting pool, the Observation Deck is the place to relax. As the largest and most spacious Observation Deck of any cruiser in Myanmar, it gives you ample room to stretch out and admire the stunning river views.

### ENTERTAINMENT

In addition to our resident pianist, a variety of local entertainers perform in the evenings, ranging from traditional Burmese puppeteers to thrilling acrobats and graceful dancers. Those looking to discover more about Myanmar's fascinating culture can attend talks and lectures from our expert guides in the Observation Lounge.

### THE BAR

The Piano Bar is decorated with a mixture of light wood and Burmese lacquerware. Tales can be shared over delicious local and international cocktails as the resident pianist plays into the night.

### WELLBEING

Indulge in one of the sumptuous beauty and massage treatments available, from a revitalising facial to a pampering aromatherapy massage.

### BOUTIQUE

A variety of delightful items are available for purchase on board as a unique memento of your trip.

# BELMOND ROAD TO MANDALAY

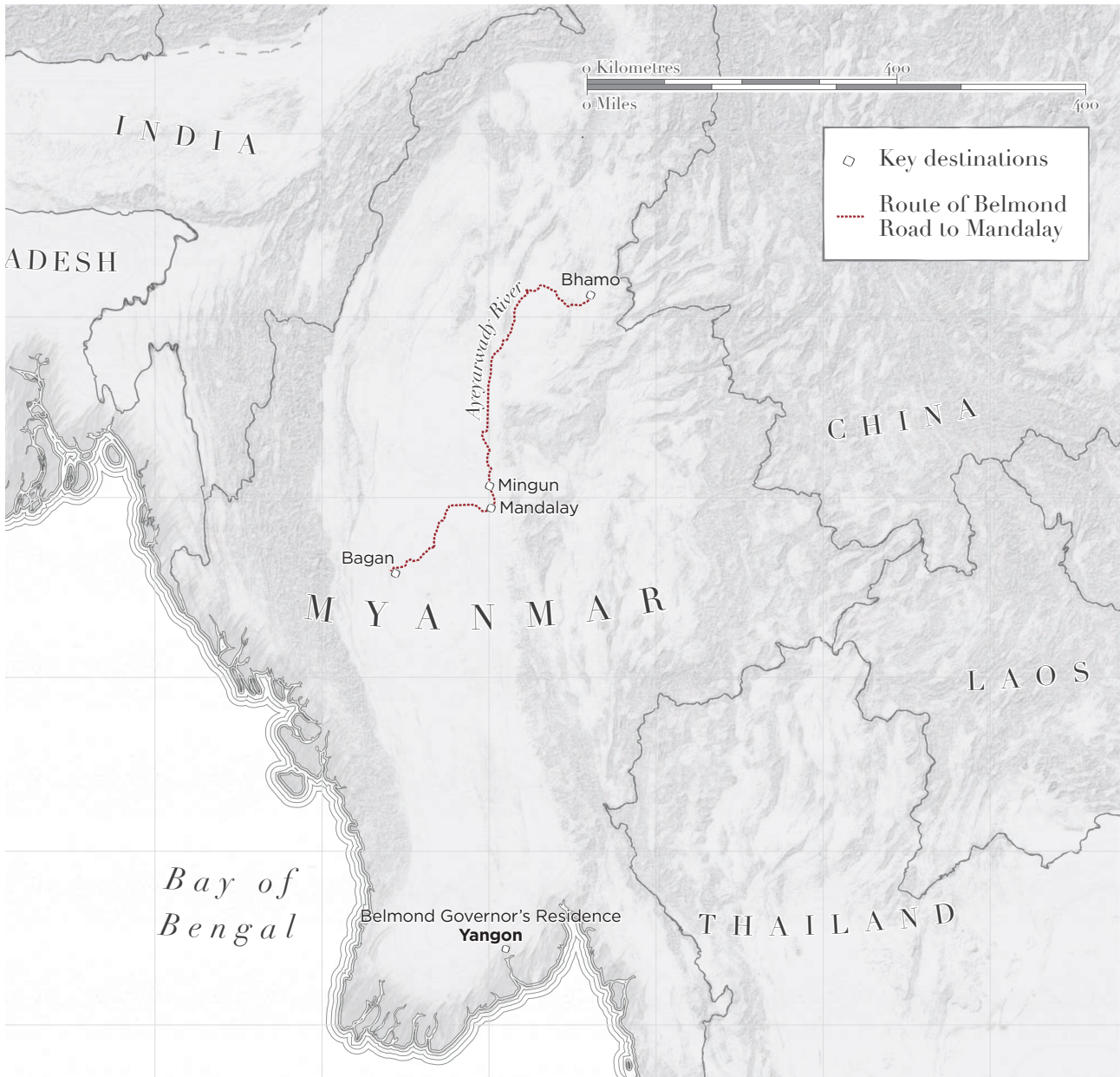

*Routes shown are for guidance only and are subject to change*

## THE JOURNEY

Whichever journey you embark on, you'll be escorted by a qualified guide with an exceptional knowledge of Myanmar and strong connections to the local communities. All routes offer a unique, genuine and personal perspective on the country.

SEASON: AUGUST TO MARCH

## WHAT'S INCLUDED

- SATELLITE WIFI IN THE OBSERVATION LOUNGE AND GOVERNOR'S SUITE
- BUTLER SERVICE IN THE GOVERNOR'S SUITE
- INDIVIDUALLY CONTROLLED AIR-CONDITIONING IN EACH CABIN
- ALL TABLE D'HÔTE MEALS (EASTERN AND WESTERN CHOICES AVAILABLE)
- SOFT DRINKS (EXCLUDING FRESH FRUIT JUICE), HOUSE BEER AND HOUSE WINE DURING LUNCH AND DINNER, ONE DAILY HOUSE COCKTAIL
- DAILY GUIDED EXCURSIONS ON LAND
- FULLY QUALIFIED DOCTOR RESIDENT ON BOARD
- PERMANENT GUIDES ON BOARD (LANGUAGES INCLUDE ENGLISH, FRENCH, GERMAN AND SPANISH)
- DAILY ONBOARD PROGRAMME, INCLUDING GUEST LECTURES
- NO SINGLE SUPPLEMENT ON SUPERIOR OR DELUXE CABINS

## BELMOND ROAD TO MANDALAY



### JOURNEYS

#### TASTE OF MYANMAR

*Mandalay – Bagan, 2 nights*

Tour monasteries and pagodas, stroll around markets and meet local craftspeople at lacquerware workshops. From the cultural capital of Mandalay to the ancient city of Ava and down to breathtaking Bagan, the highlights of this fascinating country are manifold.

#### AYEYARWADY EXPERIENCE

*Bagan – Mandalay, 2 nights*

Stunning vistas, riveting lectures and captivating tours are all in store as the ship sets sail from Mandalay to Bagan, stopping at the treasure-filled town of Mingun.

#### HIGHLIGHTS OF MYANMAR

*Mandalay – Bagan, 3 nights*

This journey takes you to the most revered sites of Mandalay as well as the awe-inspiring ancient city of Bagan.

#### IMAGES OF A GOLDEN LAND

*Bagan – Mandalay, 4 nights*

Explore the ancient temple ruins of Bagan and the pagoda-topped hills of Sagaing. Discover Mandalay and the lavish carvings of the teak Shwenandaw monastery. Visit scenic Mingun, home of the world's biggest uncracked bell.

#### NEW YEAR CELEBRATION CRUISE

*Mandalay – Bagan – Mandalay, 7 nights*

Join Belmond Road to Mandalay on an exclusive New Year's Celebration Cruise, travelling through the heart of Myanmar along the Ayeyarwady River. This journey combines unique visits, excursions and experiences with fabulous surprises for a truly unforgettable start to the New Year.



#### GORGES OF THE FAR NORTH

*Mandalay – Bhamo – Bagan, 11 nights*

Explore the wonders of hidden Myanmar in unrivalled comfort and style, marvelling at the gorges that rear up from the scenic Ayeyarwady River. This unforgettable cruise takes you to Bhamo, near the Chinese border.

*The rivers of Myanmar vary from season to season, with as much as a 30-foot variance in water level. From January through June, the Ayeyarwady's levels may drop, creating a narrower channel for navigation. To allow for these changes, Belmond Road to Mandalay may operate a revised itinerary and mooring locations may be amended.*

## BELMOND ROAD TO MANDALAY



### EXTEND YOUR STAY

Combine your river cruise with a relaxing spell on a glorious beach in Ngapali, Koh Samui or Bali, or a vibrant city break in Yangon. Let us customise your itinerary so that you do as much or as little as you please. To make your experience even more special, stay at one of our sublime Belmond hotels.

We recommend stays at the following:

- Belmond Napasai, Koh Samui, Thailand
- Belmond Jimbaran Puri, Bali
- Belmond Governor's Residence, Yangon, Myanmar
- Sandoway Beach Resort, Ngapali Beach, Myanmar

For the ultimate escape, why not head off to Inle Lake before or after your cruise and discover the area's scenic beauty and rich cultural heritage. We can arrange sightseeing visits and a stay at our suggested hotel, Inle Princess Resort. Nestling on the lake's eastern shore, it offers tranquil views over the water from secluded wooden chalets.

# BELMOND ROAD TO MANDALAY

CAPACITY	
Number of passengers	82
Number of decks	4
OBSERVATION DECK	
Top deck with pool, bar and the new Bar & Grill Restaurant	
MAIN DECK	
Restaurant, bar, Observation Lounge (with a library offering a range of books and games) and Boutique	
STATE DECK	
Governor's Suite, State Cabins, Superior Cabins and Reception	

DELUXE DECK	
Deluxe and Single Cabins, wellbeing area (which includes a fitness room and hair/beauty treatment area) and medical room	
CABINS	
Governor's Suite	1
State Cabins	18
Deluxe Cabins	16
Superior Cabins	4
Single Cabins	4

## DECK PLANS

OBSERVATION DECK

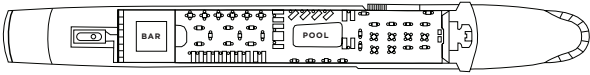

STATE DECK



MAIN DECK

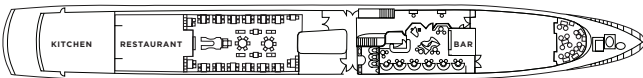

DELUXE DECK

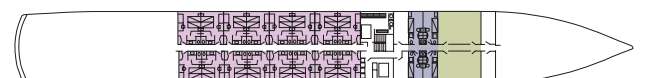

## CABIN PLANS

GOVERNOR'S SUITE

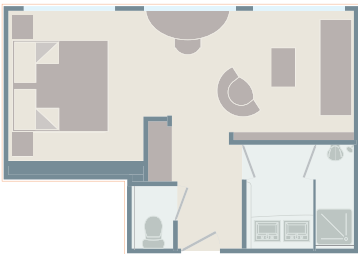

STATE CABIN

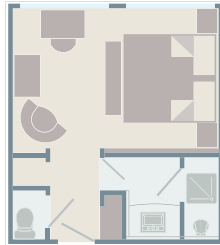

DELUXE CABIN

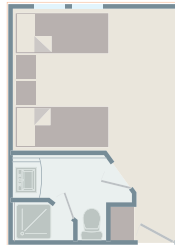

SUPERIOR CABIN



SINGLE CABIN



PLEASE CONTACT US FOR RESERVATIONS OR FURTHER INFORMATION. WE LOOK FORWARD TO HEARING FROM YOU.  
[BELMOND.COM/CONTACTUS](http://BELMOND.COM/CONTACTUS)